

Bridge Inspection Report

A5203
I-555-03-SB LNS
over
Union Pacific R/R



Inspection Date:

Inspected By:

Inspection Type(s):

TABLE OF CONTENTS

	PAGE NUMBER
LOCATION MAP	3
EXECUTIVE SUMMARY	6
NATIONAL BRIDGE INVENTORY	7
ELEMENTS	8
PICTURES	9
SKETCHES	11
MAINTENANCE NEEDS	12

Inspector:

Structure Number: A5203

Inspection Date:

Facility Carried: I-555-03-SB LNS

Bridge Inspection Report

Location Map

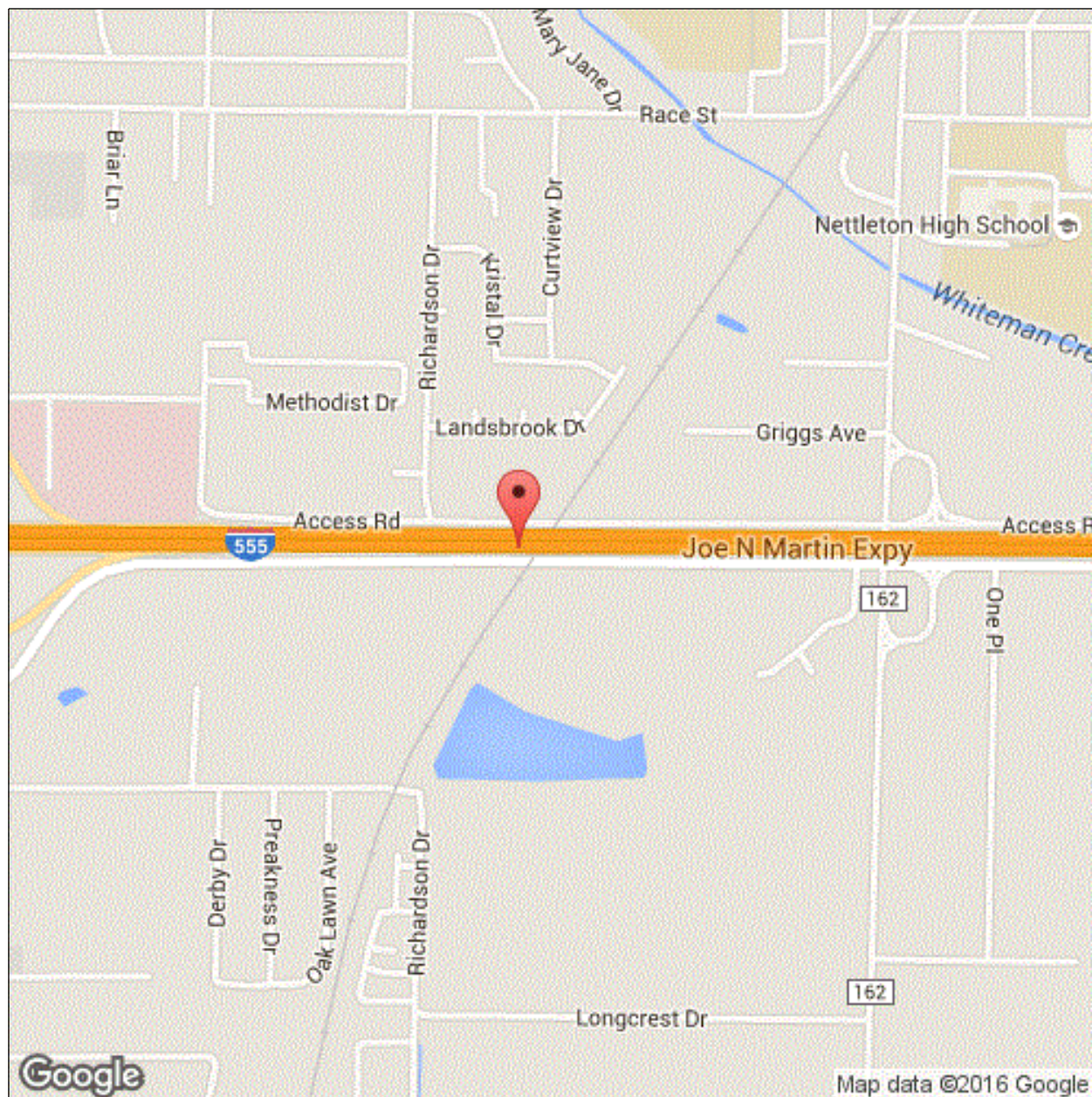

Latitude: 35.80694

Longitude: -90.65764

Inspector:

Structure Number: A5203

Inspection Date:

Facility Carried: I-555-03-SB LNS

Bridge Inspection Report

Location Map

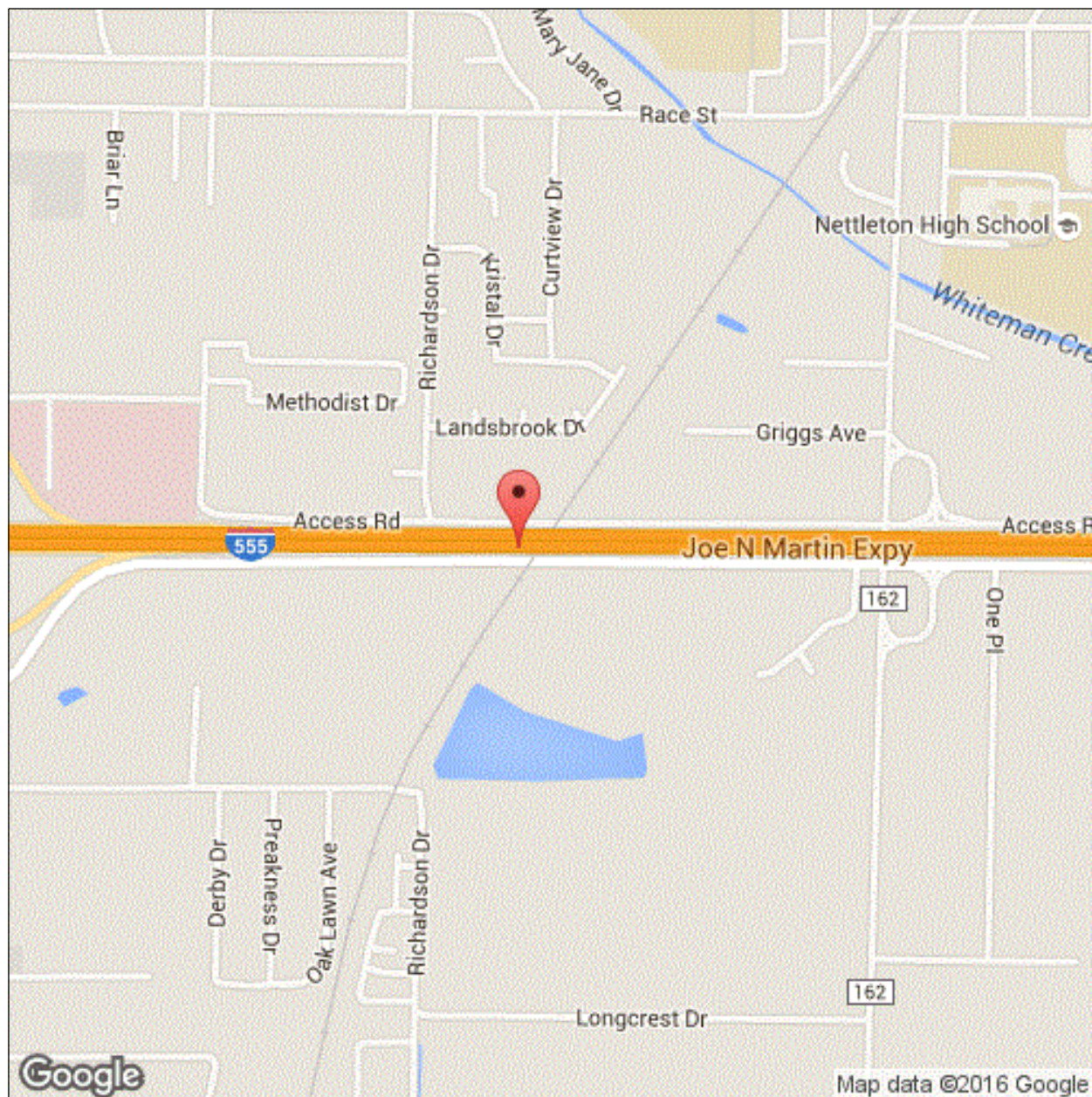

Latitude: 35.80694

Longitude: -90.65764

Inspector:

Structure Number: A5203

Inspection Date:

Facility Carried: I-555-03-SB LNS

Bridge Inspection Report

Location Map

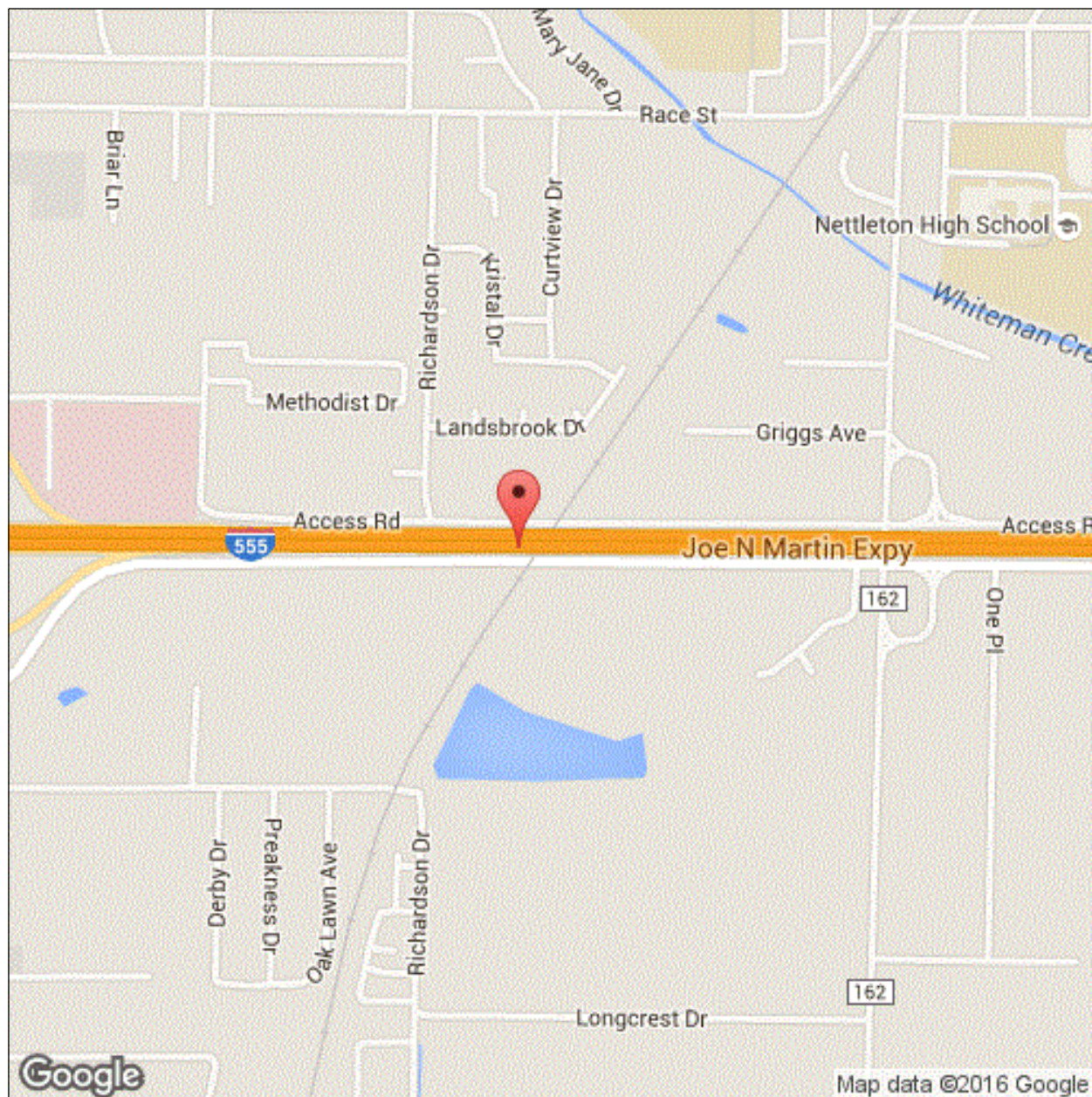

Latitude: 35.80694

Longitude: -90.65764

Inspector:

Structure Number: A5203

Inspection Date:

Facility Carried: I-555-03-SB LNS

Bridge Inspection Report

Executive Summary

Structure inspected with Hwy. 63 log.

Inspection late due to interviewing new assistant and death in inspectors family.

Inspector:

Structure Number: A5203

Inspection Date:

Facility Carried: I-555-03-SB LNS

Bridge Inspection Report

National Bridge Inventory

IDENTIFICATION		INSPECTIONS	
(1) STATE CODE	056 - Arkansas	(90) INSPECTION DATE	05/15/2018
(8) STRUCTURE NUMBER	A5203	(91) DESIGNATED INSPECTION FREQUENCY	24
(5) INV. ROUTE (ON/UNDER)	1 1 1 555 3	(92) CRITICAL FEATURE INSPECTION	(93) CFI DATE
(2) HIGHWAY AGENCY	10 (3) COUNTY CODE 031	A. FRACTURE CRITICAL DETAIL	N
(4) PLACE CODE	34720	B. UNDERWATER INSPECTION	N
(6) FEATURES INTERSECTED	Union Pacific R/R	C. OTHER SPECIAL	N
(7) FACILITY CARRIED	I-555-03-SB LNS		
(9) LOCATION	2.26 MI E JCT HWY 18		
(11) MILEPOINT 40.79	(12) BASE HIGHWAY NETWORK 1		
(13A) LRS INVENTORY ROUTE	0000063070 (13B) SUBROUTE NUMBER 01		
(16) LATITUDE 35.80694	(17) LONGITUDE -90.65764		
(98A) BORDER BRIDGE CODE			
PERCENT RESPONSIBILITY	(99) BORDER BRIDGE STRUCT		
STRUCTURE TYPE AND MATERIAL		CONDITION	
(43) STRUCTURE TYPE, MAIN		(58) DECK	6
A) KIND OF MATERIAL/DESIGN: 3 - Steel		(59) SUPERSTRUCTURE 7	(60) SUBSTRUCTURE 6
B) TYPE OF DESIGN/CONSTR: 02 - Stringer/Multi-beam or Girder		(61) CHANNEL & CHANNEL PROTECTION	N (62) CULVERT N
(44) STRUCTURE TYPE, APPROACH SPANS			
A) KIND OF MATERIAL/DESIGN: 0 - Other			
B) TYPE OF DESIGN/CONSTR: 00 - Other			
(45) NUMBER OF SPANS IN MAIN 3	(46) NUMBER OF APPROACH 0		
(107) DECK STRUCTURE TYPE 1	(108A) WEARING SURFACE 1		
(108B) DECK MEMBRANE 0	(108C) DECK PROTECTION 0		
AGE OF SERVICE		LOAD RATING AND POSTING	
(27) YEAR BUILT 1978	(106) YEAR RECONSTRUCTED 0000	(31) DESIGN LOAD	5
(42) TYPE OF SERVICE ON 1 UNDER 2		(63) METHOD USED TO DETERMINE OPERATING RATING	1
(28) LANES ON 02 UNDER 00		(64) OPERATING RATING	60.0
(29) AVERAGE DAILY TRAFFIC 25560	(19) BYPASS DETOUR LENGTH 3	(65) METHOD USED TO DETERMINE INVENTORY RATING	1
(30) YEAR OF AVERAGE DAILY TRAFFIC 2013		(66) INVENTORY RATING	36.0
(109) AVERAGE DAILY TRUCK TRAFFIC 1		(70) BRIDGE POSTING	5
		(41) STRUCTURE OPEN/POSTED/CLOSED	A
GEOMETRIC DATA		APPRAISAL	
(48) LENGTH OF MAX SPAN (ft.) 77	(49) STRUCTURE LENGTH (ft.) 234	(67) STRUCTURAL EVALUATION	6
(50) CURB/SIDEWALK WIDTHS (ft.) LEFT 0.4 RIGHT 0.4		(68) DECK GEOMETRY	6
(51) BRDG RDWY WIDTH CURB-TO-CURB (ft.)	39.0	(69) UNDERCLEARANCES, VERTICAL & HORIZONTAL	7
(52) DECK WIDTH, OUT-TO-OUT (ft.)	42	(71) WATERWAY ADEQUACY	N
(32) APPROACH ROADWAY WIDTH (ft.)	44.0	(72) APPROACH ROADWAY ALIGNMENT	8
(33) BRIDGE MEDIAN 0	(34) SKEW (DEG.) 34	(36) TRAFFIC SAFETY FEATURE	
(35) STRUCTURE FLARED 0	(10) INV RTE, MIN VERT CLEAR (ft.) 99.99	36A) BRIDGE RAILINGS:	1
(47) TOTAL HORIZONTAL CLEARANCE (ft.)	39.7	36B) TRANSITIONS:	1
(53) VERTICAL CLEARANCE OVER BRIDGE ROADWAY (ft.)	99.99	36C) APPROACH GUARDRAIL:	1
(54) VERTICAL UNDER CLEARANCE (ft.)	R 22.76	36D) APPROACH GUARDRAIL ENDS:	1
(55) LATERAL UNDER CLEARANCE RIGHT (ft.)	R 29.5	(113) SCOUR CRITICAL BRIDGES	N
(56) MIN LATERAL UNDER CLEARANCE (ft.)	0	SUFFICIENCY RATING	86.6 STATUS 0
PROPOSED IMPROVEMENTS		CLASSIFICATION	
(75A) TYPE OF WORK PROPOSED	(75B) WORK DONE BY	(112) NBIS BRIDGE LENGTH	Y
(76) LENGTH OF STRUCTURE IMPROVEMENT (ft.)	0	(104) HIGHWAY SYSTEM OF THE INVENTORY ROUTE	1
(94) BRIDGE IMPROVEMENT COST (\$)	0	(26) FUNCTIONAL CLASSIFICATION OF INVENTORY ROUTE	11
(95) ROADWAY IMPROVEMENT COST (\$)	0	(100) STRAHNET HIGHWAY DESIGNATION	1
(96) TOTAL PROJECT COST	0	(101) PARALLEL STRUCTURE DESIGNATION	R
(97) YEAR OF IMPROVEMENT COST ESTIMATE		(102) DIRECTION OF TRAFFIC	1
(114) FUTURE ADT 14091	(115) YEAR OF FUTURE ADT 2028	(103) TEMP STRUCTURE	
		(105) FEDERAL LANDS HIGHWAYS	0
		(110) DESIGNATED NATIONAL NETWORK	1
		(20) TOLL	3
		(21) MAINTENANCE RESPONSIBILITY	01
		(22) OWNER	01
		(37) HISTORICAL	5
		NAVIGATION DATA	
		(38) NAVIGATION CONTROL	N
		(111) PIER OR ABUTMENT PROTECTION	5
		(39) NAV VERT CLEARANCE (ft.)	0
		(116) MIN NAVIGATION VERT CLEARANCE, VERT LIFT BRIDGE (ft.)	0
		(40) NAV HORIZONTAL CLEARANCE (ft.)	0

Inspector:

Structure Number: A5203

Inspection Date:

Facility Carried: I-555-03-SB LNS

Bridge Inspection Report

Element Inspection

	Environment	Total Quantity	Units	Condition State 1	Condition State 2	Condition State 3	Condition State 4
12 - Reinforced Concrete Deck	1- Ben.	9828	sq. ft.	7302	2526	0	0
1090 - Exposed Rebar		54			54		
1120 - Efflorescence/Rust Staining		55			55		
1130 - Cracking (RC and Other)		2417			2417		
107 - Steel Open Girder/Beam	1- Ben.	1617	ft.	1575	0	42	0
1000 - Corrosion		42				42	
515 - Steel Protective Coating		14168	sq. ft.	12908	0	1260	0
3440 - Effectiveness (Steel Protective Coatings)		1260				1260	
205 - Reinforced Concrete Column	1- Ben.	4	each	1	2	1	0
1090 - Exposed Rebar		1				1	
1120 - Efflorescence/Rust Staining		2			2		
215 - Reinforced Concrete Abutment	1- Ben.	120	ft.	106	14	0	0
1130 - Cracking (RC and Other)		14			14		
234 - Reinforced Concrete Pier Cap	1- Ben.	98	ft.	89	9	0	0
1080 - Delamination/Spall/Patched Area		3			3		
1090 - Exposed Rebar		4			4		
1130 - Cracking (RC and Other)		2			2		
302 - Compression Joint Seal	1- Ben.	188	ft.	0	0	138	50
2320 - Seal Adhesion		97				47	50
2330 - Seal Damage		91				91	
311 - Movable Bearing	1- Ben.	21	each	0	0	21	0
1000 - Corrosion		19				19	
1020 - Connection		2				2	
313 - Fixed Bearing	1- Ben.	21	each	0	0	21	0
1000 - Corrosion		21				21	
321 - Reinforced Concrete Approach Slab	1- Ben.	1584	sq. ft.	1568	0	16	0
1130 - Cracking (RC and Other)		16				16	
330 - Metal Bridge Railing	1- Ben.	468	ft.	468			
331 - Reinforced Concrete Bridge Railing	1- Ben.	468	ft.	381	87	0	0
1130 - Cracking (RC and Other)		87			87		

Inspector:

Inspection Date:

Structure Number: A5203

Facility Carried: I-555-03-SB LNS

Bridge Inspection Report

Pictures

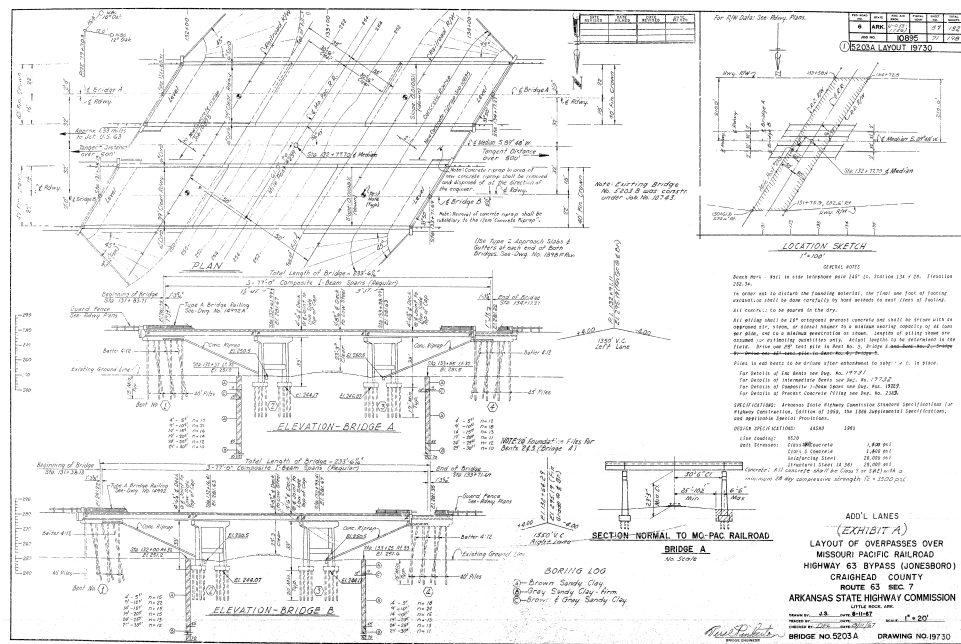

PHOTO 1

Description

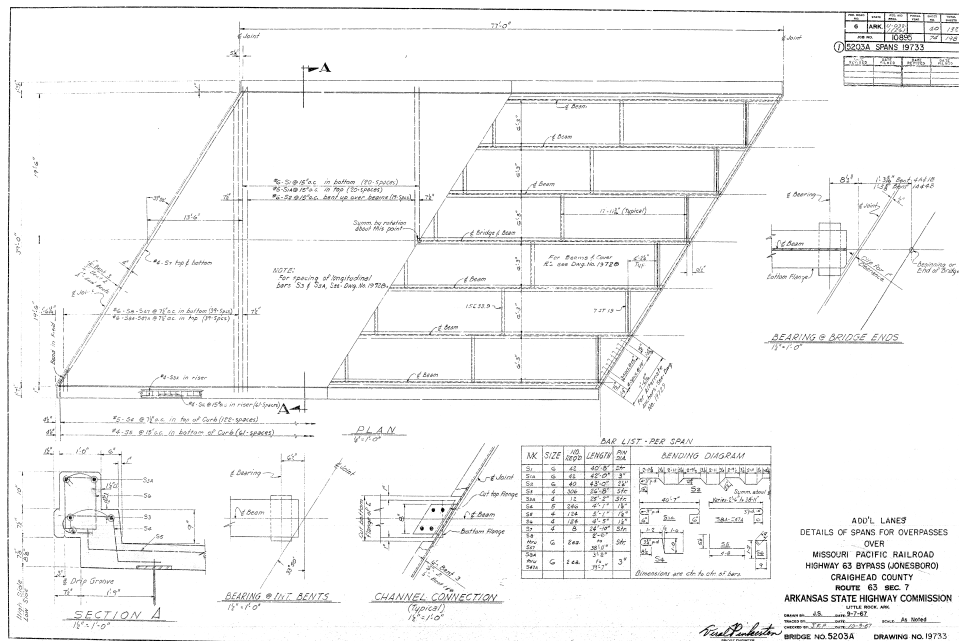

PHOTO 2

Description

Inspector:

Inspection Date:

Structure Number: A5203

Facility Carried: I-555-03-SB LNS

Bridge Inspection Report

Pictures

PHOTO 2

Description

Inspector:

Inspection Date:

Structure Number: A5203

Facility Carried: I-555-03-SB LNS

Bridge Inspection Report

Sketches

Inspector:

Structure Number: A5203

Inspection Date:

Facility Carried: I-555-03-SB LNS

Bridge Inspection Report

Maintenance Needs

Date Reported: 4/24/2012 12:00:00 AM

Priority: C - Important

Work Code:

Deficiency Description:

Steel rocker bearings

Bent 2 Rocker Bearing 1 on Sp 3 side has one end of cotter pin broken off.

Bent 2 Rocker Bearing 7 on Sp 3 side has a cotter pin missing.

Work Description:

Date Repairs Completed:

Maintenance Comments:

Date Reported: 4/24/2012 12:00:00 AM

Priority: C - Important

Work Code:

Deficiency Description:

Concrete caps and Abutments.

Caps and Abutments have a few minor vertical cracks.

Work Description:

Date Repairs Completed:

Maintenance Comments:

Inspector:

Structure Number: A5203

Inspection Date:

Facility Carried: I-555-03-SB LNS

Bridge Inspection Report

Maintenance Needs

Date Reported: 4/24/2012 12:00:00 AM

Priority: C - Important

Work Code:

Deficiency Description:

Bent 3 conc. column 1

2 ft. area of vertical cracks and impending spall located 5 ft. below bottom of cap.

Work Description:

Date Repairs Completed:

Maintenance Comments:

Stage: Monitor



PHOTO 1 Description

Inspector:

Structure Number: A5203

Inspection Date:

Facility Carried: I-555-03-SB LNS

Bridge Inspection Report

Maintenance Needs

Date Reported: 4/24/2012 12:00:00 AM

Priority: C - Important

Work Code:

Deficiency Description:

North Approach Slab with asphalt overlay
Several shelled areas with rough surface..

Work Description:

Date Repairs Completed:

Maintenance Comments:

Date Reported: 4/24/2012 12:00:00 AM

Priority: C - Important

Work Code:

Deficiency Description:

Concrete deck
Numerous open unsealed cracks thru deck with some efflor.

Work Description:

Date Repairs Completed:

Maintenance Comments:

Date Reported: 4/24/2012 12:00:00 AM

Priority: C - Important

Work Code:

Deficiency Description:

Compression seals
Bent 1 & 4 compression seals are split and torn.
Bent 3 compression seal is losing adhesion and dropped down 2 to 3 inches.
Bent 2 compression seal has fallen out.

Work Description:

Date Repairs Completed:

Maintenance Comments:

Inspector:

Inspection Date:

Structure Number: A5203

Facility Carried: I-555-03-SB LNS

Bridge Inspection Report

Maintenance Needs

Date Reported: 4/24/2012 12:00:00 AM

Priority: C - Important

Work Code:

Deficiency Description:

Steel Girders

Steel girders have 20% paint deterioration and surface rust.

Work Description:

Date Repairs Completed:

Maintenance Comments:

Inspector:

Structure Number: A5203

Inspection Date:

Facility Carried: I-555-03-SB LNS

Bridge Inspection Report

Maintenance Needs

Date Reported: 4/24/2012 12:00:00 AM

Priority: C - Important

Work Code:

Deficiency Description:

Span 1 Girder 1

Girder is out of plumb 1 in. in 12 in. or 4 degrees, See 2018 photo.

Span 2

Sp 2 has a lateral shift of 1 1/4 in. at bent 2 or 20 degrees. See 2018 photo.

Work Description:

Date Repairs Completed:

Maintenance Comments:

Stage: Monitor



PHOTO 1 Description

Stage: Monitor



PHOTO 2 Description

Inspector:

Inspection Date:

Structure Number: A5203

Facility Carried: I-555-03-SB LNS

Bridge Inspection Report

Maintenance Needs

Stage: Monitor



PHOTO 3 Description

Stage: Monitor



PHOTO 4 Description

Inspector:

Structure Number: A5203

Inspection Date:

Facility Carried: I-555-03-SB LNS

Bridge Inspection Report

Maintenance Needs

Date Reported: 05/04/2016

Priority: C - Important

Work Code:

Deficiency Description:

Span 2 Right curb and overhang at bent 3.
5 ft. spalled with no exposed rebar. See 2016 photo.

Work Description:

Date Repairs Completed:

Maintenance Comments:

Stage: Open



PHOTO 1 Description

Inspector:

Structure Number: A5203

Inspection Date:

Facility Carried: I-555-03-SB LNS

Bridge Inspection Report

Maintenance Needs

Date Reported: 05/16/2018

Priority: C - Important

Work Code:

Deficiency Description:

Bent 2 concrete columns 1 have horizontal cracking with efflorescence and vertical crack, no exposed rebar. See photo 2018

Work Description:

Date Repairs Completed:

Maintenance Comments:

Stage: Open



PHOTO 1 Description